

“service,
strength and
quality”

2,000 kg
Slave Pot
Hauler

THISTLE GROUP



The 2,000 kg slave pot hauler is a robust, harsh environment capable rope hauler suitable for a variety of purposes. With maintenance free bearings and constructed from sea water corrosion resistant components. This hauler is capable of hauling rope from 8mm to 16mm diameter by adjustment of the sheaves and ejector knife to ensure optimal performance. The integrated auxiliary capstan drum allows additional rope hauling activities to be performed. Supplied with or without mounting bracket and with hand or foot pedal control as required.



Technical Data	
Maximum Line Speed:	4.89 m/s
Recommended Working Speed:	1—2 m/s
Working Pressure:	210 bar
Maximum Oil Flow:	200 LPM
Weight (without bracket):	170 kg

Rope Line Pull Capacity	
Rope Diameter	Pull Force (kg)
8mm	1,160
10mm	1,160
12mm	1,160
14mm	1,160
16mm	1,160
Capstan Drum	2,051

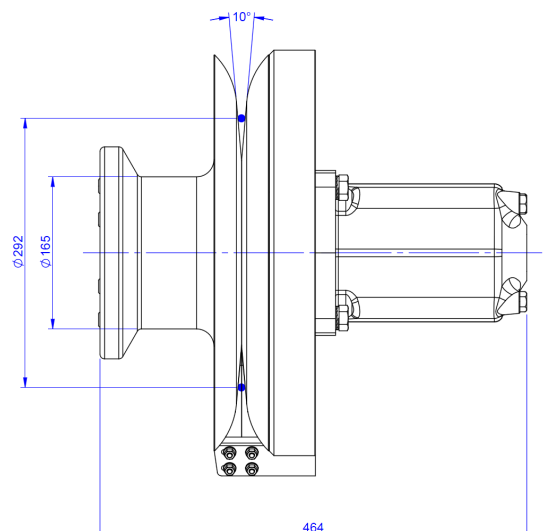
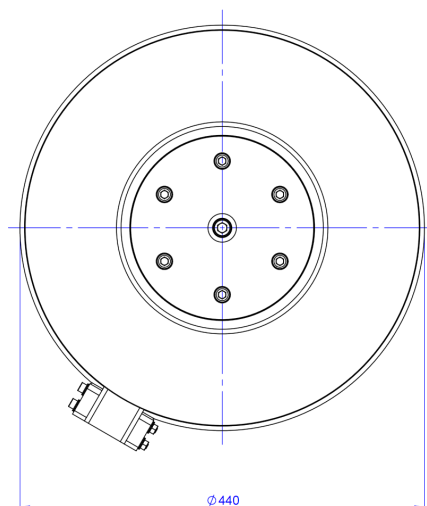

THISTLE GROUP HQ
5 Baltic Place, Peterhead,
Aberdeenshire, Scotland,
AB42 1TF
Tel: +44 (0)1779 477 210
sales@thistlemarine.co.uk
www.thistlegroup.co.uk